

ITEM NO.	PART NO.	DESCRIPTION	QTY.
1	10646/00	TOWEL BAR, 24"L x .0625" THK	1
2	92049	SCREW BUTTON HD CAP 1/4"-20 THRD X 7/8"L	2
3	10642/00	EXTENSION POST, TP HOLDER	2
4	10639/00	ESCUTCHEON, WALL MOUNT CONTEMP.	2
5	30042	WALL MOUNTING PLATE	2
6	92043	SCREW, FLAT HD #10 SIZE W/ #2 PHIL DRIVE, 2"L	4
7	92046	ANCHOR SCREW 3/8" HOLE, TOGGLER AF10	4
8	92008	SET SCREW, CUP POINT 8-32, 3/16" L.	2

A

B

C

D

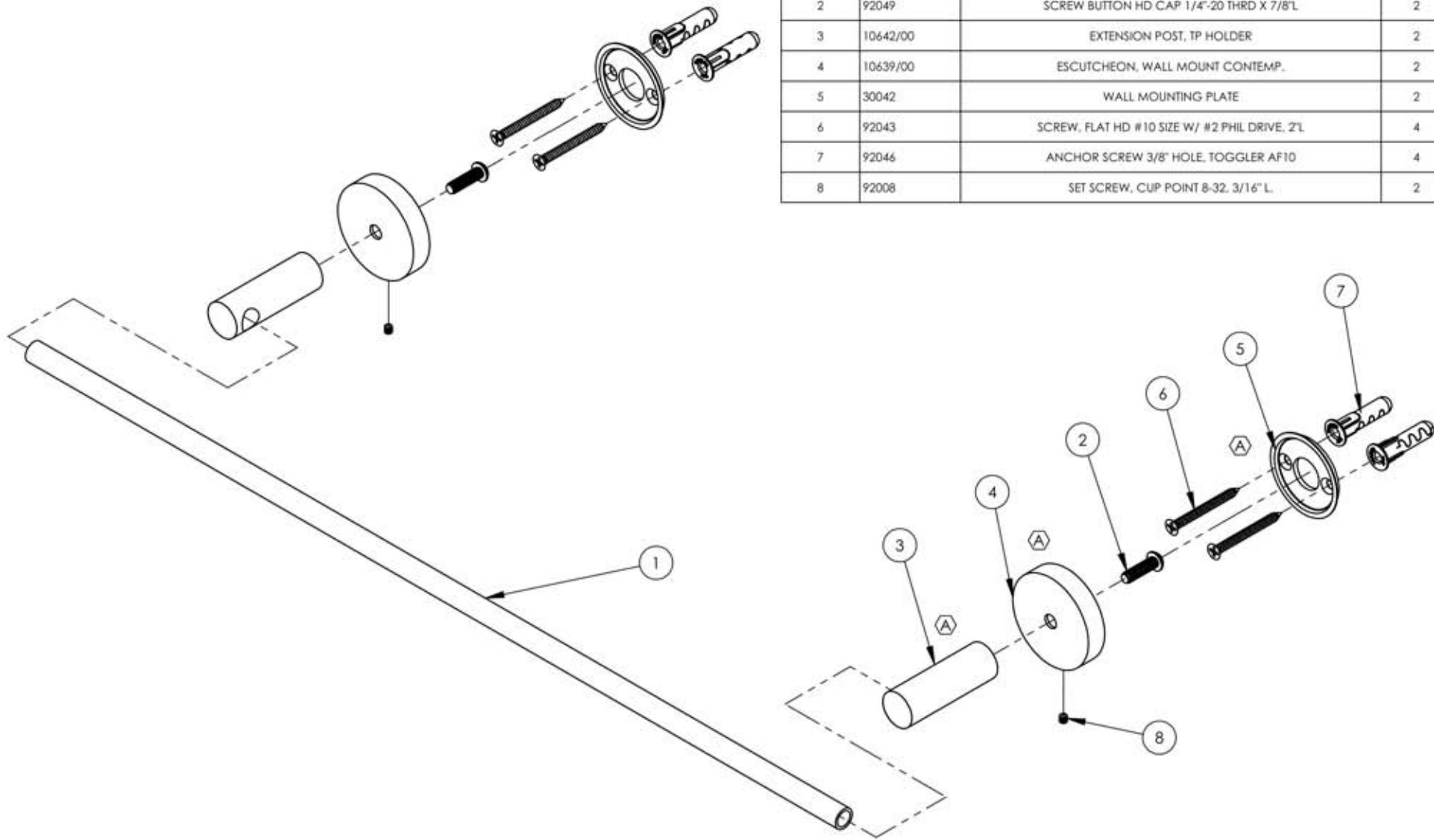

C2	A	REPLACED ESCUTCHEON, EXT. POST & MOUNTING HARDWARE	4/12/2018	RAH
ZONE	REV.	DESCRIPTION	DATE	APPROVED

REVISIONS

1261 LOGAN AVENUE
COSTA MESA, CALIFORNIA 92626
PHONE: 714.361.4800
FAX: 714.617.3120

PHYLORICH®

Defining Luxury Since 1959

PROPRIETARY AND CONFIDENTIAL
THE INFORMATION CONTAINED IN THIS DRAWING IS THE SOLE PROPERTY OF R3S MANUFACTURING. ANY REPRODUCTION IN PART OR AS A WHOLE WITHOUT THE WRITTEN PERMISSION OF R3S MANUFACTURING IS PROHIBITED.

NEXT ASSY	USED ON	FRACTIONS ±1/64"	DECIMALS X.X: ±.1 X.XX: ±.01 X.XXX: ±.005	ANGULAR ±.5°
APPLICATION		MATERIAL	NAME	DATE
FINISH		DRAWN	10/9/2013	
DO NOT SCALE DRAWING		CHECKED		

INTERPRET GEOMETRIC DIMENSIONING & TOLERANCING IN ACCORDANCE WITH ASME Y14.5-2009 & ASME Y14.41-2003 STANDARDS. UNLESS OTHERWISE SPECIFIED, DIMENSIONS ARE IN INCHES. TOLERANCES ARE:

24" TOWEL BAR, BASIC SERIES

SIZE	ASM/PRT NO.	REV
A	DB70/00	A

SCALE: 1:3 WEIGHT: lbs. SHEET 1 OF 2

5

4

3

2

1